



MagnaClean DRX® Magnetic Filter

MagnaClean DRX Series 3"

SUBMITTAL DATA *MagnaClean DRX 3"*

ISSUE DATE 12/2022

Job name	Size
Job location	Quantity
Engineer	Approval
Mechanical contractor	Service
Contractor's P.O. No.	Tag No.
Representative	Notes

Application

In closed loop heating and chiller systems, the circulation of water contaminants such as copper, chloride, iron, scale, and pH imbalances may result in rapid corrosion, damage, and blockages to components such as pumps, control valves, thermostats, heat exchangers, heat emitters and pipes, resulting in lower thermal efficiency within the system and even component failures.

The ASME and CRN approved *MagnaClean DRX* magnetic filter provides compact and cost-effective filtration performance for light to medium commercial closed loop heating and cooling applications. Its unique magnetic belt technology makes servicing quick and easy, and its 6" servicing clearance makes it ideal for applications with limited space.

Delivering a market leading and patented design, easy-to-service capabilities, improved system efficiencies, reduced maintenance and running costs, the DRX range is an integral part of water management solutions and services for commercial heating and chilled water systems.

Dimensions

MagnaClean DRX 3"

Filter flow rate: 170gpm

Dry weight: 36.2 lbs

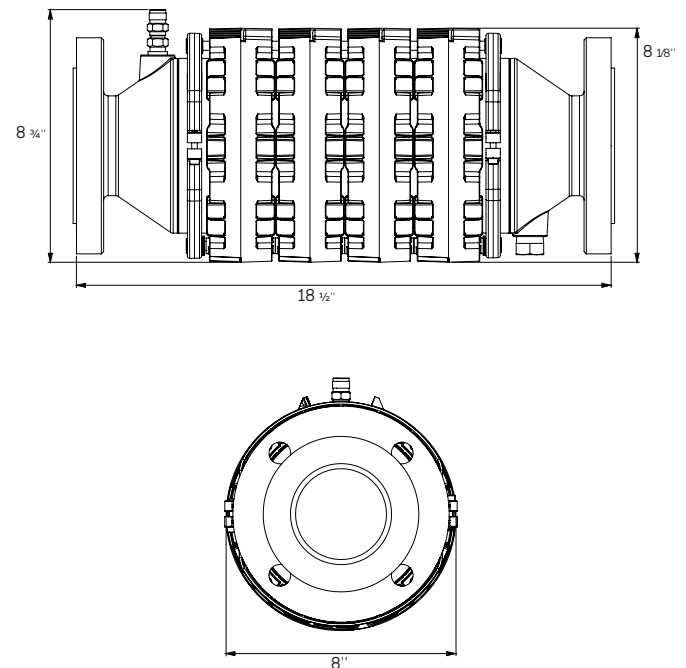



Typical Specification

Furnish and install on the plans and described herein, an ADEY® *MagnaClean DRX* magnetic filter as manufactured by ADEY. Each filter must be designed with a 304L stainless-steel body with large internal volume, seals in EPDM, blowdown drain port, air vent, external spring-loaded magnetic belt with 64 individual neodymium magnets.

Each magnetic filter shall be an ADEY *MagnaClean DRX* model or approved equal.

(See product instructions for specific installation information.)

Pressure Drop Data

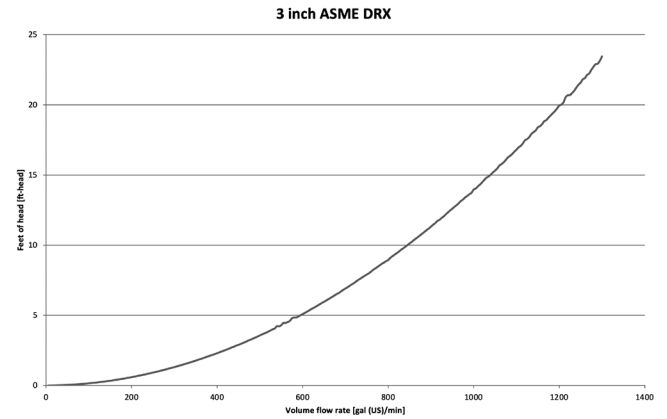

Technical Data

Filter body: 304L Stainless Steel

Filter belt casing: Glass reinforced nylon

Magnets (x64): Neodymium rare-earth

Magnets – dimensions: 3/4" Dia x 1/2" Thk

Gasket seal: EPDM

Drain point thread: 3/4" NPT

Air vent body: CB754S Brass

Air vent float: PE

Air vent spring: Stainless steel

Flow flange: ANSI

Flange type: B16.5 Class 150

Flange diameter: 7 1/2"

Flange thickness: 1"

Bolt size: 5/8"

Bolt quantity: 8

Bolt hole PCD: 6"

Performance

Suitable fluids: Water, glycol solution

Maximum percentage of glycol: 50%

Maximum working pressure: 232 psi (16 bar)

Maximum working temperature: 212°F (100°C)

Particle separation capacity: down to 5 µm (0.2 mil)

Inlet & Outlet: 3" flanged

Flow rate: 270 g/pm