

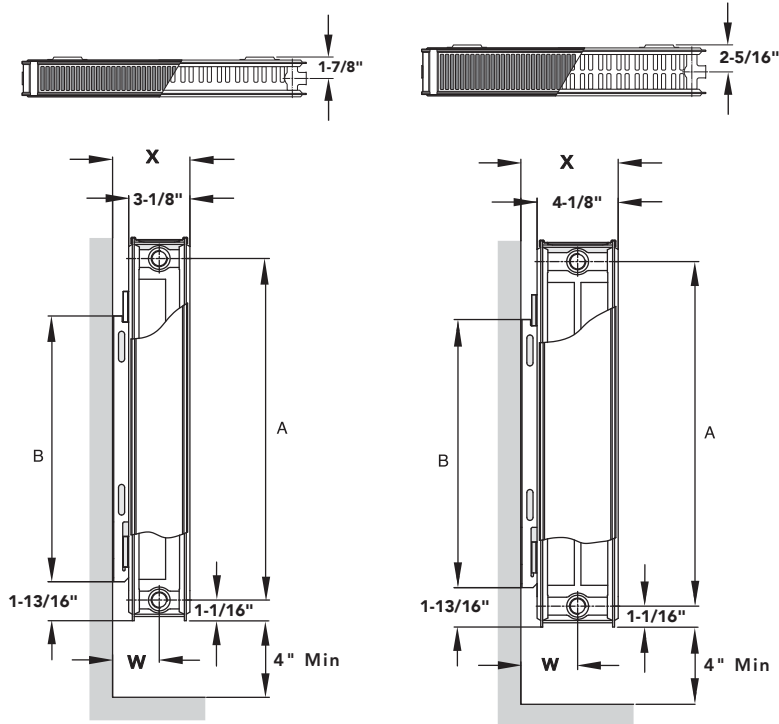

SX Type 21 and SD Type 22 models



Mounting Bracket	Type 21		Type 22	
	Dimension (in) X	Dimension (in) W	Dimension (in) X	Dimension (in) W
KOM (BH) Short Side*	4 <sup>1</sup> / <sub>16</sub>	2 <sup>1</sup> / <sub>2</sub>	5 <sup>1</sup> / <sub>16</sub>	2 <sup>15</sup> / <sub>16</sub>
KOM (BH) Long Side*	4 <sup>7</sup> / <sub>16</sub>	2 <sup>15</sup> / <sub>16</sub>	5 <sup>7</sup> / <sub>16</sub>	3 <sup>3</sup> / <sub>8</sub>
SIGARTH (EZ)	4 <sup>1</sup> / <sub>2</sub>	2 <sup>15</sup> / <sub>16</sub>	5 <sup>1</sup> / <sub>2</sub>	3 <sup>3</sup> / <sub>8</sub>

\*From wall to radiator

Nominal Height (in)	A (in)	B (in)
11 <sup>13</sup> / <sub>16</sub>	9 <sup>11</sup> / <sub>16</sub>	6
15 <sup>3</sup> / <sub>4</sub>	13 <sup>5</sup> / <sub>8</sub>	10
23 <sup>5</sup> / <sub>8</sub>	21 <sup>1</sup> / <sub>2</sub>	17 <sup>13</sup> / <sub>16</sub>
29 <sup>1</sup> / <sub>2</sub>	27 <sup>3</sup> / <sub>8</sub>	23 <sup>3</sup> / <sub>4</sub>

All Dimensions are nominal

SX Type 21

SD Type 22

	Order Code	Nominal Length (mm - inches)	Output* (Btu/h)	Weight (lbs)	Water Content (gals)	Order Code	Output* (Btu/h)	Weight (lbs)	Water Content (gals)
Height 300mm - 12in	SX30 60VN	600 - 23 <sup>3</sup> / <sub>8</sub>	1857	22	0.56	SD30 60VN	2430	26	0.56
	SX30 100VN	1000 - 39 <sup>1</sup> / <sub>8</sub>	3095	36	0.90	SD30 100VN	4050	42	0.90
	SX30 140VN	1400 - 55 <sup>1</sup> / <sub>8</sub>	4333	49	1.27	SD30 140VN	5670	58	1.27
	SX30 180VN	1800 - 70 <sup>1</sup> / <sub>8</sub>	5570	62	1.64	SD30 180VN	7290	74	1.64
Height 400mm - 16in	SX40 50VN	500 - 20 <sup>1</sup> / <sub>2</sub>	1982	26	0.56	SD40 50VN	2603	31	0.56
	SX40 60VN	600 - 23 <sup>3</sup> / <sub>8</sub>	2379	29	0.68	SD40 60VN	3124	35	0.68
	SX40 70VN	700 - 28 <sup>1</sup> / <sub>8</sub>	2775	34	0.79	SD40 70VN	3645	41	0.79
	SX40 80VN	800 - 31 <sup>1</sup> / <sub>2</sub>	3172	38	0.87	SD40 80VN	4165	46	0.87
	SX40 90VN	900 - 36 <sup>1</sup> / <sub>4</sub>	3568	43	0.98	SD40 90VN	4686	52	0.98
	SX40 100VN	1000 - 39 <sup>1</sup> / <sub>8</sub>	3965	47	1.10	SD40 100VN	5207	57	1.10
	SX40 120VN	1200 - 47 <sup>1</sup> / <sub>4</sub>	4758	56	1.32	SD40 120VN	6248	68	1.32
	SX40 160VN	1600 - 63	6344	74	1.77	SD40 160VN	8331	89	1.77
Height 600mm - 24in	SX60 40VN	400 - 15 <sup>1</sup> / <sub>4</sub>	2233	27	0.68	SD60 40VN	2900	31	0.68
	SX60 50VN	500 - 20 <sup>1</sup> / <sub>2</sub>	2791	34	0.84	SD60 50VN	3625	39	0.84
	SX60 60VN	600 - 23 <sup>3</sup> / <sub>8</sub>	3349	39	1.01	SD60 60VN	4350	45	1.01
	SX60 70VN	700 - 28 <sup>1</sup> / <sub>8</sub>	3907	46	1.08	SD60 70VN	5075	53	1.08
	SX60 80VN	800 - 31 <sup>1</sup> / <sub>2</sub>	4466	51	1.31	SD60 80VN	5800	59	1.31
	SX60 90VN	900 - 36 <sup>1</sup> / <sub>4</sub>	5024	58	1.47	SD60 90VN	6525	67	1.47
	SX60 100VN	1000 - 39 <sup>1</sup> / <sub>8</sub>	5582	63	1.64	SD60 100VN	7251	73	1.64
	SX60 110VN	1100 - 44 <sup>1</sup> / <sub>8</sub>	6140	70	1.81	SD60 110VN	7976	81	1.81
	SX60 120VN	1200 - 47 <sup>1</sup> / <sub>4</sub>	6698	75	1.98	SD60 120VN	8701	87	1.98
	SX60 130VN	1300 - 52	7257	82	2.15	SD60 130VN	9426	95	2.15
Height 700mm - 30in	SX70 40VN	400 - 15 <sup>1</sup> / <sub>4</sub>	2534	33	0.82	SD70 40VN	3258	42	0.82
	SX70 50VN	500 - 20 <sup>1</sup> / <sub>2</sub>	3168	42	1.02	SD70 50VN	4072	53	1.02
	SX70 60VN	600 - 23 <sup>3</sup> / <sub>8</sub>	3802	50	1.23	SD70 60VN	4887	63	1.23
	SX70 70VN	700 - 28 <sup>1</sup> / <sub>8</sub>	4435	58	1.43	SD70 70VN	5701	71	1.43
	SX70 80VN	800 - 31 <sup>1</sup> / <sub>2</sub>	5069	65	1.59	SD70 80VN	6516	79	1.59
	SX70 90VN	900 - 36 <sup>1</sup> / <sub>4</sub>	5702	73	1.79	SD70 90VN	7330	89	1.79
	SX70 100VN	1000 - 39 <sup>1</sup> / <sub>8</sub>	6336	81	1.99	SD70 100VN	8144	102	1.99
	SX70 120VN	1200 - 47 <sup>1</sup> / <sub>4</sub>	7603	98	2.40	SD70 120VN	9773	119	2.40
	SX70 140VN	1400 - 55 <sup>1</sup> / <sub>8</sub>	8871	114	2.81	SD70 140VN	11402	135	2.81
	SX70 160VN	1600 - 63	10138	131	3.22	SD70 160VN	13031	154	3.22

\* Outputs are based on an AWT of 180°F and EAT of 68°F.  
For outputs based on other AWT please consult our radiator correction chart.

Specifications below are per Linear Foot

Order Code	Nominal Height (inches)	Btuh/ft at 160°F EWT**	Weight (lbs/ft)	Water Content (gals/ft)	Order Code	Btuh/ft at 160°F EWT**	Weight (lbs/ft)	Water Content (gals/ft)
SX30 XXXVN	11 <sup>13</sup> / <sub>16</sub>	679	11.18	0.285	SD30 XXXVN	889	13.21	0.285
SX40 XXXVN	15 <sup>3</sup> / <sub>4</sub>	870	14.73	0.345	SD40 XXXVN	1143	17.78	0.345
SX60 XXXVN	23 <sup>5</sup> / <sub>8</sub>	1225	19.81	0.513	SD60 XXXVN	1591	22.86	0.513
SX70 XXXVN	29 <sup>1</sup> / <sub>2</sub>	1391	25.40	0.625	SD70 XXXVN	1788	32.00	0.625

\*\* Outputs are based on an EWT of 160°F with delta T of 20°F and EAT of 68°F.