



PRESTIGE CASCADE SYSTEM

Saves Space. Saves Time. Saves Money!



Note: Photo shows from left to right: Reverse Return, Reverse Return with Valves and Primary Secondary Piping Options. Hydraulic Junction shown is included with Primary Secondary System only.

Among the most energy efficient, environmentally friendly, commercial gas fired hot water heating system available today.

ACV – Triangle Tube offers factory prefabricated boiler manifolds with capacities from 500,000 Btu/hr. to 2 million BTU's (two to five boilers) in two different piping arrangements: Primary Secondary (P/S), Reverse Return (R/R)

The Cascade System features multiple, high efficiency, fully modulating, low water content boilers, where off cycle losses are substantially reduced and dissipated heat from stored water is far less than a single large capacity boiler.



Prestige Cascade System

Product Specifications

Cascade Kit P/N	# of Manifolds	# of Solo 250 or 399 Boilers	Total Input MBH Note 1	Total Output MBH Note 1 & 2	Total Net IBR Rating MBH Note 3	Total EDR Water Ft2 Note 4	Total Output Boiler Horse-Power	Minimum Recommended System Iron Pipe Size Note 5	Minimum Recommended Natural Gas Header Size Note 6
C (PS or RR) 500	1	2 (250)	43.6 - 480	444	386	2,574	13.3	2"	2"
C (PS or RR) 800	1	2 (399)	72.5 - 798	758	659	4,399	22.6	3"	2"
C (PS or RR) 1000	2	4 (250)	43.6 - 960	888	772	5,148	26.5	3"	2.5"
C (PS or RR) 1200	1	3 (399)	72.5 - 1,197	1,138	990	6,599	34.0	4"	2.5"
C (PS or RR) 1600	2	4 (399)	72.5 - 1,596	1,518	1,320	8,799	45.3	4"	3"
C (PS OR RR) 2000	2	5 (399)	72.5 - 1,995	1,897	1,650	10,999	56.6	4"	3"

System	Cascade Kit P/N	Total Water Content (Gal.)	Total Shipping Weight (Lbs)	Length (inches)	Height (inches)	Depth (inches)
Primary Secondary (Including hydronic junction)	CPS 500	23	725	86"	72"	36"
	CPS 800	29	841	86"	72"	36"
	CPS 1000	38	1,326	154"	72"	36"
	CPS 1200	39	1,125	113"	72"	36"
	CPS 1600	50	1,558	154"	72"	36"
	CPS 2000	59	1,842	181"	72"	36"
Reverse Return	CRR 500	15	601	68"	72"	33"
	CRR 800	21	717	68"	72"	33"
	CRR 1000	30	1,202	136"	72"	33"
	CRR 1200	31	1,001	95"	72"	33"
	CRR 1600	42	1,434	136"	72"	33"
	CRR 2000	51	1,718	163"	72"	33"

Note 1: Input and output ratings are shown for sea level applications. The PRESTIGE Solo automatically derates the input at approximately 2% for every 1,000 feet of altitude. No alteration to the boiler or burner system is required.

Note 2: PRESTIGE Solo 399 output ratings are based off a thermal efficiency of 95.1%. PRESTIGE Solo 250 output is based on DOE heating capacity.

Note 3: The IBR rating is based on piping and pick up allowance of 1.15. This allowance should be sufficient for standard radiation requirements.

Note 4: Equivalent Direct Radiation (EDR) is based on 150 Btu/h per square foot at 170°F average supply temperature.

Note 5: Minimum recommended system iron pipe size is based on temperature differential of 20°F.

Note 6: Minimum recommended natural gas header size is based on using schedule 40 metallic pipe 0.30" w.c. pressure drop and 100 feet of total equivalent length at inlet gas pressure of less than 2 psi. Consult National Fuel Gas Code for alternate sizing.

Product Data

CPS Standard Equipment

- Prestige Solo 250 or 399 boilers
- Cascade manifold
- Hydronic junction
- Grundfos circulator (1 per boiler)
- ANSI flange kit
- Air vent
- Installation hardware

CRR Standard Equipment

- Prestige Solo 250 or 399 boilers
- Cascade manifold
- ANSI flange kit
- Installation hardware

Optional Equipment

- Common venting manifold kit
- CSD-1 Kits Complete with low water cut-off and fittings
- WYE strainer (reverse return only)

Optional Common Vent System (for 399 boilers only)

2 Boiler Common Vent

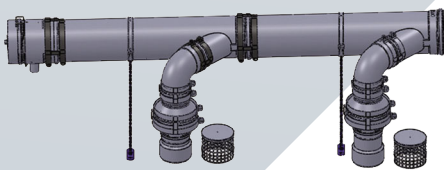

- ULC S636 approved vent system
- Single penetration
- Prefit piping to reduce installation time

3 Boiler Common Vent

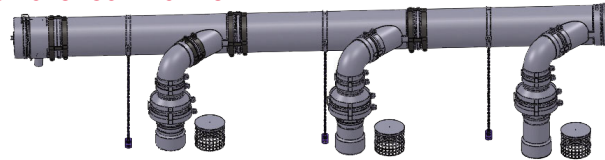

- Terminations and flashing available
- Polypropylene construction

Triangle Tube reserves the right to make product changes or improvements at any time without notice.



Triangle Tube • One Triangle Lane • Blackwood NJ 08012 • www.triangletube.com

p 856.228.8881 f 856.228.3584